

tegula, mayfair & mourne circles



laying guidelines v1.0

The following information is provided as guidance from Tobermore on how to lay your Tegula, Mayfair & Mourne Circles.

The basic circle pattern guide

row	no. of blocks	type
1	1	Circle centre
2	8	Pointed
3	8	Pointed
3	8	Small rectangular
4	24	Tapered
5	24	Tapered
5	8	Small rectangular
6	24	Tapered
6	16	Small rectangular
7	24	Tapered
7	24	Small rectangular

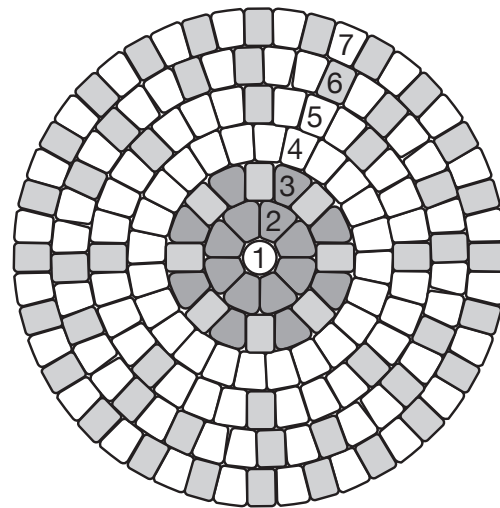

Note

After row 7, the Paving Circle diameter can be increased using Tegula Setts, Mayfair Setts and the Mourne Circle using Mourne 115s.

We provide you with the optimum number of bricks to create a circle, size 1.5m diameter. To achieve the best possible circle it is recommended that you follow this pattern precisely. It should be noted, however, that in outer rows of the circle you may need to provide spaces between the blocks.

For further assistance please contact the sales office, Tobermore.

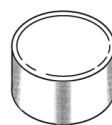

Circle centre

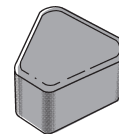

Pointed block

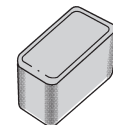

Small rectangular

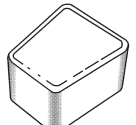

Tapered block

instructions & warnings

(as referred to in Tobermore's Conditions of Sale)

Any technical information provided by Tobermore in relation to any product (whether before or after order) is provided by way of GUIDANCE ONLY and, to the fullest extent permitted by law, without liability on the part of Tobermore for any loss or damage suffered as a result of relying upon it. Such technical information should not be relied upon in substitution for obtaining independent expert advice prior to using any product from both a suitably qualified engineer and building contractor, in particular, as to the suitability of the product for use at the intended site for the intended scheme.

CORE TERMS (PAVING & WALLING)

Product

All products should be carefully inspected for defects or damage upon delivery and prior to being laid or fitted.

Product Information

Within Tobermore, design and development of products is a continuing process, and product information is subject to change without notice. Accordingly, please check with Tobermore to ensure that the product information you have represents the most up-to-date product information.

Installation

All products should be installed in accordance with the latest British Standard.

Colour

Tobermore produces paving and walling products with excellent density and durability, however, as with all concrete products, slight colour variations and/or weathering may occur.

Although every effort is made to ensure consistency of product colour, variations between production batches can occur. Tobermore therefore recommends that when purchasing products, especially in larger quantities, they all come from the same batch and that products are thoroughly mixed on site by drawing from a minimum of 3 pallets.

The colour of new paving blocks, flags and walling products will inevitably vary compared to those which have been laid for a period of time.

All colour illustrations in Tobermore's brochures are as accurate as the printing process will allow. For a more accurate colour match, please refer to actual product samples available from any of Tobermore's Paving and Walling Centres.

Efflorescence

Efflorescence is a white crystalline deposit that occurs naturally on the surface of concrete materials. If it occurs, efflorescence may mask the colour of the product for a period of time, but tends to be washed away gradually by rain.

Surface Scratches

Minor scuffs or bruises may occur during installation (for example, during any plate vibrating process). In Tobermore's experience, these marks usually weather off through time.

Ordering

To avoid waste, please ensure that your contractor accurately measures the area on site before ordering products. In Tobermore's experience, dimensions taken from a project plan can vary significantly from the final layout.

Manufacturing & Quality systems

Tobermore is a BS EN ISO 9001:2000 and BS EN ISO 14001 registered company. Tobermore uses an integrated management system to manage all health & safety and environmental issues.

Product Maintenance

Routine cleaning and maintenance is required to keep the overall appearance of products in pristine condition.

Laying multi-blend coloured paving blocks, flags and walling products
To achieve an even blend of colour when laying multi-blend paving blocks, flags and walling products, it is desirable to mix from 3 or 4 different pallets.

Queries & Complaints

Please contact one of Tobermore's Paving & Walling Centres or offices (contact details at www.tobermore.co.uk) with any queries or complaints. Any complaints must be notified to Tobermore without delay.

CORE TERMS (PAVING ONLY)

Product Maintenance

Light coloured paving blocks and flags emphasise tyre marks and oil spills on the driveway. Please note that these products will need more maintenance if overall appearance is to be maintained.

Initial Cleaning

When an area has just been paved, allow it to settle for a few days. After this, you may wish to lightly hose down the paving to remove any excess sand or dirt. The area should then be treated with a weed killer suppressant 2-3 times per year as required.

General Cleaning

Paving requires regular maintenance, including regular sweeping to prevent the build up of detritus. Tobermore recommends that paving is cleaned 2-3 times per year.

For general cleaning of dirt and algae, vigorous brushing with a stiff yard brush with plenty of hot detergent solution (washing up liquid or non-bio washing powder), thoroughly rinsed with clean water, should suffice. Repeated treatment may be required for paved areas sited beneath trees or in permanent/near permanent shade.

A light power hose at medium pressure is generally all that is required to clean general dirt and grime. Any jointing material which is removed must be replaced. Do not use high pressure powerwashers as aggressive powerwashing can damage the product surface. A trial area should be tested before large scale powerwashing takes place.

Moss, Lichen and Algae

Thick growths of moss or lichen must be removed first by scraping out the joints and then treating the area with a moss killer such as anti-moss paving cleaner. Anti-moss is designed to remove moss, lichens and algae. It is best applied in dry weather. After being applied it will take a few days to be fully effective. Once the moss and lichens have been killed, they can easily be brushed off. Anti-moss also leaves a residue in the sand joint which will help reduce the likelihood of re-growth. The manufacturer's instructions should always be followed when using any cleaning agent.

Weeds

Large weeds should be removed by hand and then the area treated with a weed killer (available from any good garden centre). Smaller weeds can then be treated directly with weed killer and these weeds should start to die within days. The manufacturer's instructions should always be followed when using any weed killing agent.

Block Paving Sealer

It is possible to seal block paving with a resin material which combats staining and weed growth and which also enhances colour and appearance. The acrylic sealer is sprayed onto the block paving and forms a 'skin' on top of the paving and the jointing material giving an easily maintained finish. The manufacturer's instructions should always be followed when using any sealing agent.



Tobermore
www.tobermore.co.uk